

1

2

3

4

5

6

A

A

B

B

C

C

D

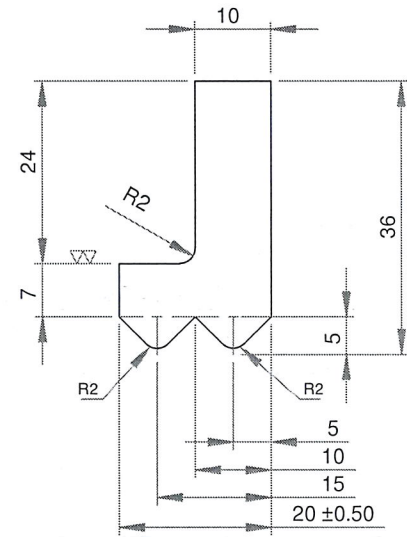
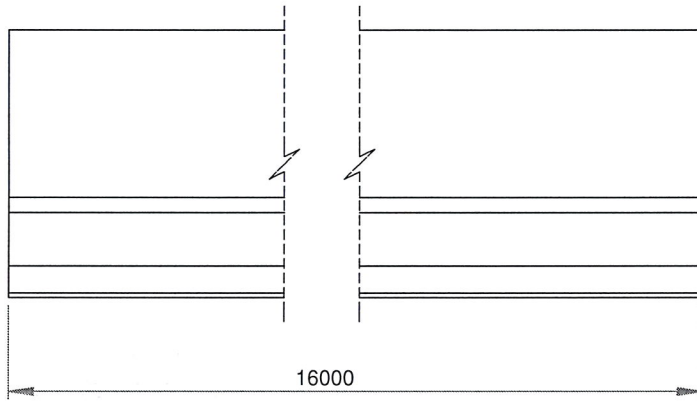

** INCOMING PART WILL BE CHECK. IT WILL RETURN IF NOT PASS **

POLISHING	GRINDING	NORMAL MACHINING (SMOOTH SURFACE)	NORMAL MACHINING (ROUGH SURFACE)
▽▽▽	▽▽	▽	▽

1	RUBBER SEAL MOULD CAR	1	NBR	50-60 (SHORE-A)
POS	DESCRIPTION	QTY	MATERIAL	REMARKS
FILE DIR: \\192.168.4.15\mechanical\Draft Nuryana\Proyek Pak Rully\MCA\Rubber mould car\		SCALE: 1:200		DIM: mm
DIM: mm		NAME		DATE
DRAWN		ENDEN		15-May-18
DESIGN		AVAILABLE		
CHECK		RULLY		15/05/18
APRV		RULLY		
CANCEL DWG NO.		-		151
REF DWG NO.				
		TITLE		MOULD CAR
				MECHANICAL ENGINEERING SECTION
				RUBBER SEAL



PT SCG LIGHTWEIGHT CONCRETE INDONESIA

A4

2012-DWG-MCA-MC-M-(1-50)-1

REV NO. PAGE

1