

Display Purchase Req. 1021012102

Document Overview On Personal Setting

2010 PR frm MRP/CBP 1021012102

Header

Default Values

| Requisn Date | St... | Item | A | I | M | Short Text | Quantity | Unit | Delivery Date | P... | Requisitioner | Matl Group | Plant | Stor. Loc. | Purch. Grp | Total Value |
|--------------|-------|------|---|---|---|---------------------------------|----------|------|---------------|------|---------------|------------|---------|------------|------------|-------------|
| 20.06.2022 | | 10 | K | | | Repair Bucket Elevator (as dwg) | 24 | PC | 02.08.2022 | 1 | Taufik | Supplies | PT SLCI | | DBA | 6,000,000 |

Item [10] Repair Bucket Elevator (as dwg)

Material Data Quantities/Dates Valuation Account Assignment Source of Supply Status Contact Person Texts Delivery Address Spec2000 / SC

Item Texts

- Item text
- Item note
- Delivery text
- Material PO text

A...

Purpose :
[10] Repair bucket for ready to use Bucket Elevator sand.
Details : 2012-DWG-RMA-BE01-M-110

GL : 523072
CC : 2011-10000

Continuous-tex...

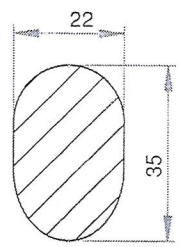
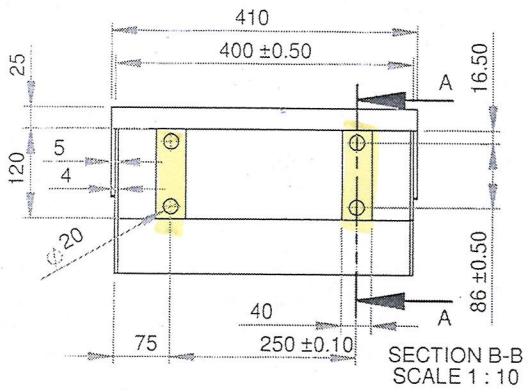
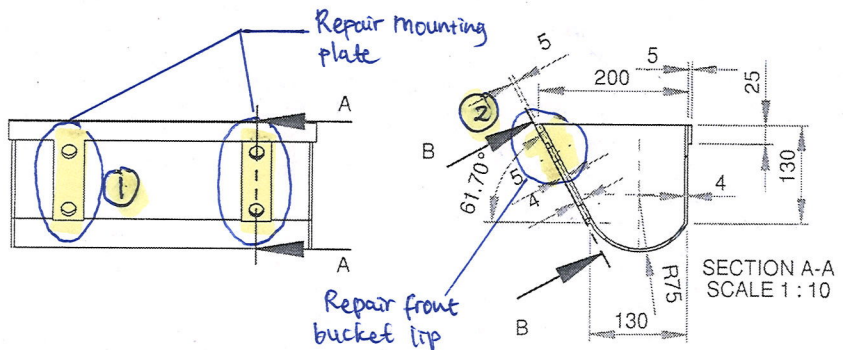

SECTION E-E
SCALE 2 : 3

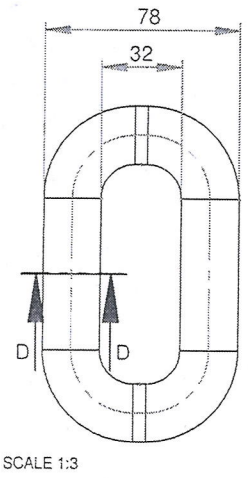

SECTION D-D
SCALE 1 : 3

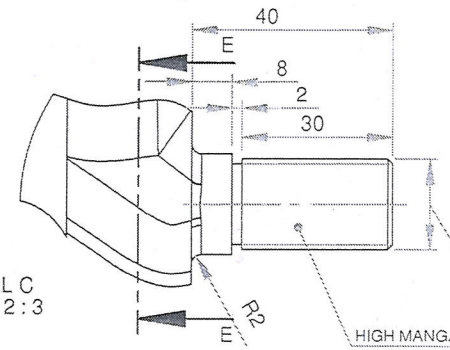
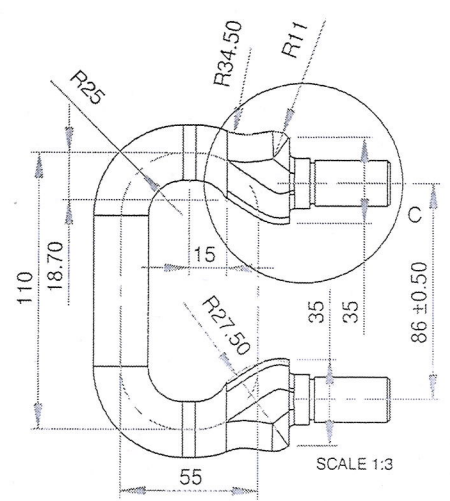

DETAIL C
SCALE 2 : 3

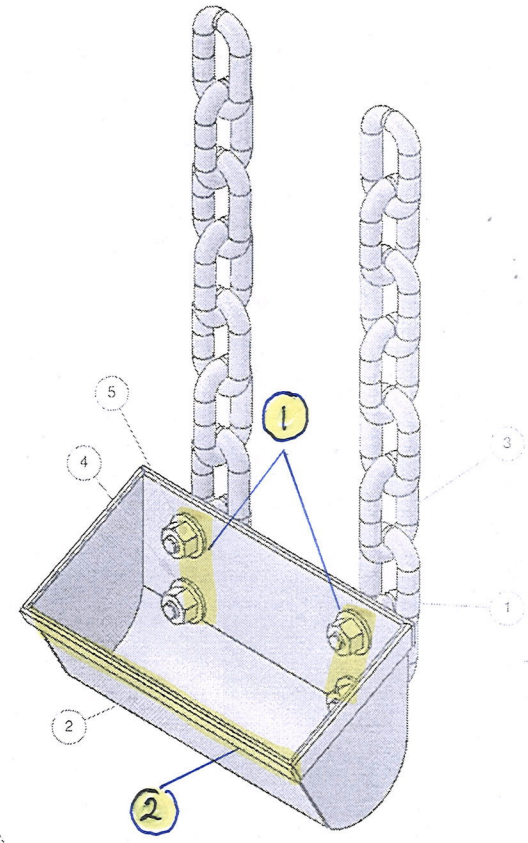

ISOMETRIC VIEW
SCALE 1:8

| | | | | |
|-----|------------------|-----|--------------------------------|------------------------------------|
| 5 | NUT M18x2.5 | 2 | HTBN 8.8 | |
| 4 | WASHER PLATE M18 | 2 | SPRING STEEL | |
| 3 | CHAIN EYE | 14 | HIGH MANGANESE STEEL (FORGING) | CASTING PROCESS WILL BE ACCEPTABLE |
| 2 | BUCKET | 1 | ANTI WEAR PLATE | HARDOX 500 OR COMPATIBLE |
| 1 | LOCKING CHAIN | 2 | HIGH MANGANESE STEEL (FORGING) | CASTING PROCESS WILL BE ACCEPTABLE |
| POS | DESCRIPTION | QTY | MATERIAL | REMARKS |

FILE DIR: \\192.168.4.15\mechanical\Draft Nuryana\Proyek Pak Yessiko\Bucket elevator\ SCALE: 1:20 DIM: mm ASSY NO.

| | | |
|----------------|------------|-----------|
| DIM: mm | NAME | DATE |
| DRAWN | ENDEN | 03-Sep-18 |
| DESIGN | AVAILABLE | 3/19/18 |
| CHECK | YESSIKO | |
| APRV | M. NUGRAHA | |
| CANCEL DWG NO. | | |
| REFF DWG NO. | | |

MECHANICAL ENGINEERING SECTION
TITLE BUCKET ELEVATOR 01

ASSEMBLY SEVEN CHAIN LINK (EXISTING)

** INCOMING PART WILL BE CHECK. IT WILL RETURN IF NOT PASS **

| | | | |
|-----------|----------|-----------------------------------|----------------------------------|
| POLISHING | GRINDING | NORMAL MACHINING (SMOOTH SURFACE) | NORMAL MACHINING (ROUGH SURFACE) |
| | | | |