

Display Purchase Req. 1021014536

Document Overview On Personal Setting

2010 PR frm MRP/CBP

Header

Default Values

Requisn Date	St...	Item	A	I	M	Short Text	Quantity	Unit	Delivery Date	P...	Requisitioner	Matl Group	Plant	Stor. Loc.	Purch. Grp	Total Value
03.01.2024		10	K			Hammer Crusher	12	PC	12.02.2024	1	Robby	Supplies	PT SLCI		DBA	16,800,000

Item

Material Data | Quantities/Dates | Valuation | Account Assignment | Source of Supply | Status | Contact Person | Texts | Delivery Address | Spec2000 / SC

Item Texts	A...	
Item text	<input checked="" type="checkbox"/>	Purpose: For Crusher Machine in Raw Material GL: 523072 CC: 2011-11900
Item note	<input type="checkbox"/>	
Delivery text	<input type="checkbox"/>	
Material PO text	<input type="checkbox"/>	

Continuous-tex...

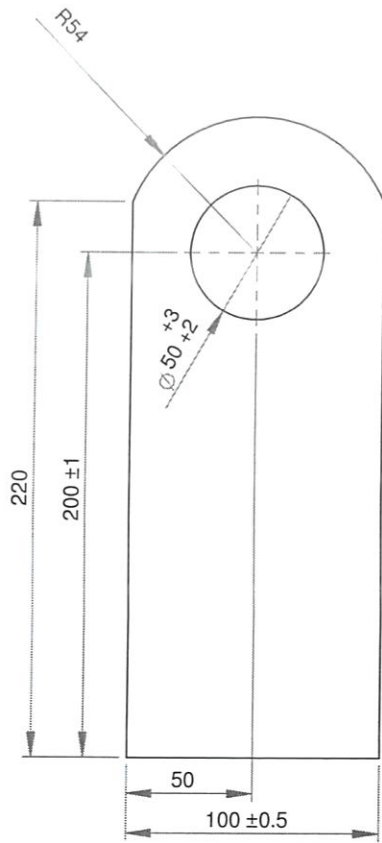

SCALE 1 : 3

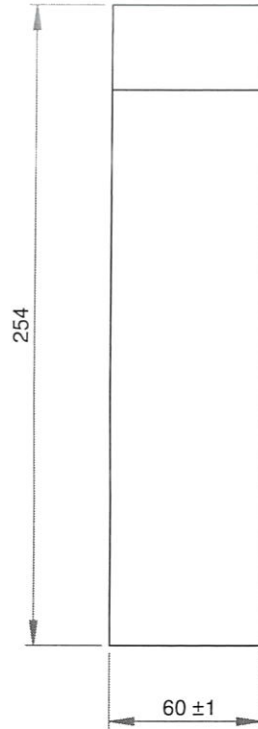

SCALE 1 : 3

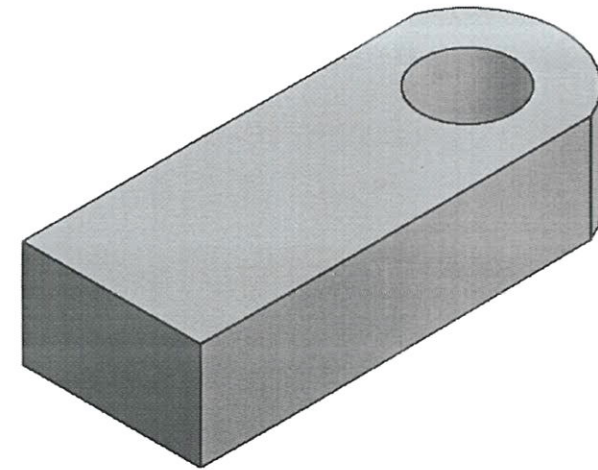

SCALE 1 : 3

** INCOMING PART WILL BE CHECK. IT WILL RETURN IF NOT PASS **

POLISHING	GRINDING	NORMAL MACHINING (SMOOTH SURFACE)	NORMAL MACHINING (ROUGH SURFACE)
▽▽▽	▽▽	▽	▽

1	HAMMER CRUSHER	1	HIGH MANGANESE STEEL 12%	10.5 Kg/pcs
POS	DESCRIPTION	QTY	MATERIAL	REMARKS
FILE DIR: \\192.168.4.15\mechanical\Draft Nuryana\Proyek Pak Yessiko\CRUSHER\Hammer crusher		SCALE: 1:5		ASSY NO.
DIM: mm		NAME		DATE
DRAWN		ENDEN	8/15/2017	
DESIGN		ENDEN		
CHECK		YESSIKO	<i>Yessiko 15-12</i>	
APRV		RULLY	<i>Rully</i>	
CANCEL DWG NO.				
REF DWG NO.				
MECHANICAL ENGINEERING SECTION				
TITLE				
HAMMER CRUSHER				



PT SCG LIGHTWEIGHT CONCRETE INDONESIA

A4 2012-DWG-RMA-CR-M-001

REV NO. PAGE

1